

3/F, 5/F-12/F, 15/F-16/F Floor Plan

La Salle Residence

D	
訂價	
2房 400'	
15	\$14,447,000 @ \$36,118
10	\$13,363,000 @ \$33,408
9	\$13,171,000 @ \$32,928
7	\$12,798,000 @ \$31,995
6	\$12,616,000 @ \$31,540
5	\$12,435,000 @ \$31,088
3	\$12,253,000 @ \$30,633

E	
訂價	
1房 297'260'	
10	\$10,597,000 @ \$35,680
6	\$9,606,000 @ \$32,343
2	\$7,989,000 @ \$30,727

F	
訂價	
1房 306'269'	
10	\$11,072,000 @ \$36,183
6	\$10,037,000 @ \$32,801
2	\$8,265,000 @ \$30,725

A	
訂價	
2房 419'	
15	\$17,465,000 @ \$41,683
9	\$15,070,000 @ \$35,967
7	\$14,672,000 @ \$35,017
6	\$14,473,000 @ \$34,542
5	\$14,274,000 @ \$34,067

C	
訂價	
2房 402'	
15	\$14,295,000 @ \$35,560
10	\$13,160,000 @ \$32,736
9	\$12,967,000 @ \$32,256
7	\$12,605,000 @ \$31,356
6	\$12,424,000 @ \$30,905
5	\$12,242,000 @ \$30,453
3	\$12,060,000 @ \$30,000

B	
訂價	
2房 414'	
15	\$17,077,000 @ \$41,249
9	\$14,734,000 @ \$35,589
7	\$14,201,000 @ \$34,302
6	\$14,013,000 @ \$33,848
5	\$13,815,000 @ \$33,370

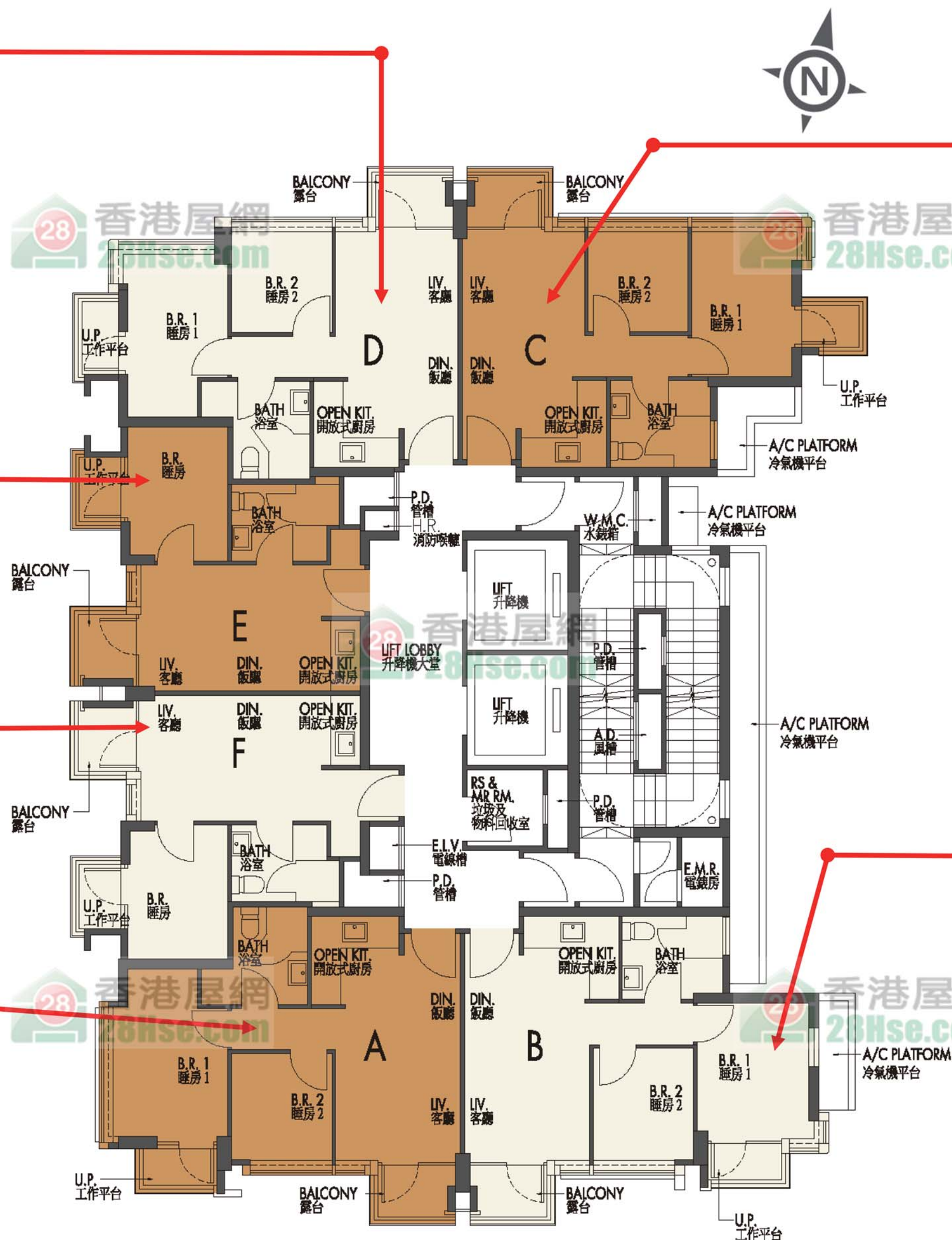

以上單位訂價圖由28HSE製作

製作日期：2019年7月9日

資料來源：新盤網頁(晟林)